



# ELECTRIC RICE COOKER

Model: PPRC612



PowerPac Electrical Pte Ltd

✉ [sales@powerpac.com.sg](mailto:sales@powerpac.com.sg)

📘 PowerPacSG

🌐 [www.powerpac.com.sg](http://www.powerpac.com.sg)

🎵 @powerpacsg



WE ARE OFFERING A  
**15% OFF** STOREWIDE FOR  
YOUR NEXT PURCHASE AT  
[WWW.POWERPAC.COM.SG](http://WWW.POWERPAC.COM.SG)

CODE  
**THANKYOU15**

## PARTS & DESCRIPTION

This appliance possesses the following features: a removable power cable for convenience; large heating plate to accelerate the heating process; and a Stainless Steel Pot. Its safety features include auto Warm function which automatically changes from 'COOK' to 'WARM' when the cooking time has expired. It is light, easy to handle, easy to operate, uses less electricity due to its high energy efficiency, and provides pots of fragrant rice for many years to come.

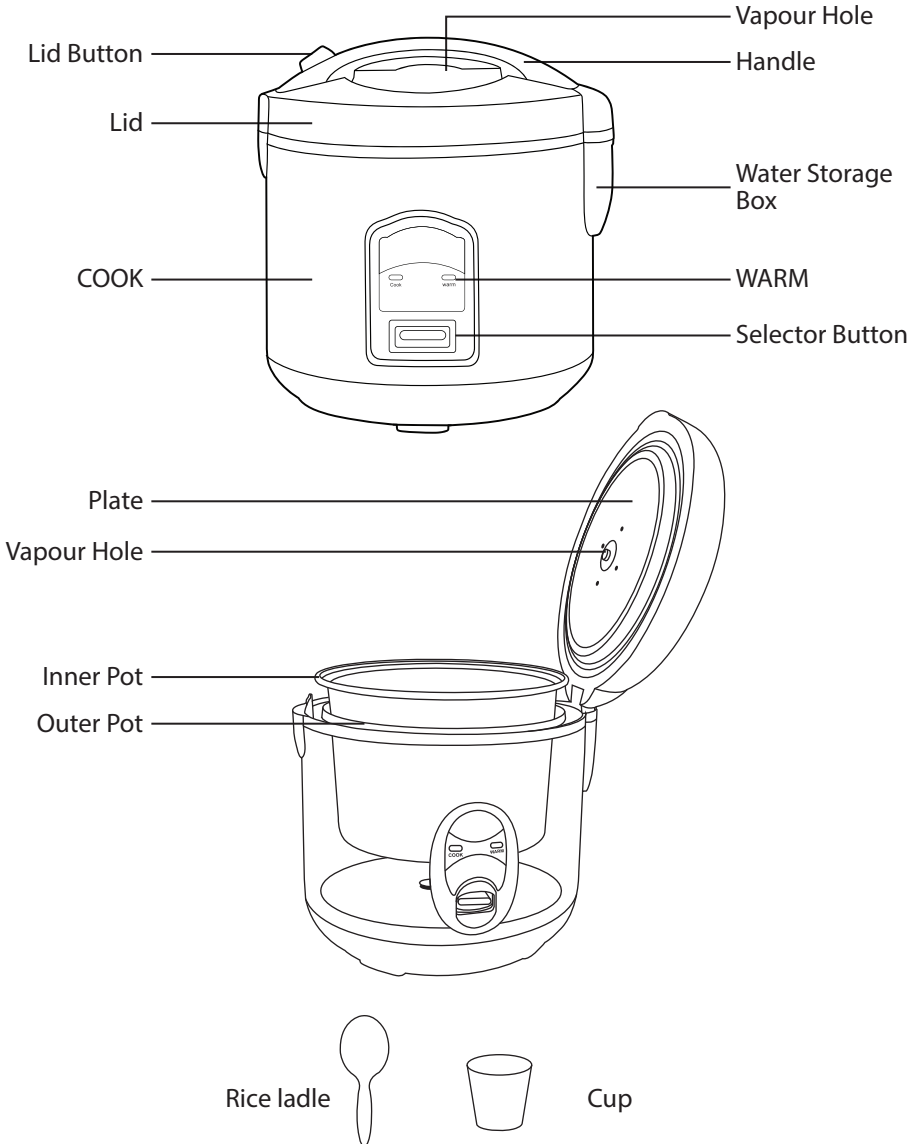

## WARNINGS

### ATTENTION :

Read this booklet carefully it as contains important instructions for a safe installation, use and maintenance. Important instructions to be kept for future reference.

The following basic precautions should always be followed when using electrical appliances:

1. Read all instructions before using the appliance.

### The Appliance

2. This appliance must be used only for the purpose it was expressly designed; any use NOT complying with the instructions contained in the manual is considered inappropriate and dangerous. The manufacturer is NOT responsible for possible damages caused by the inappropriate and/or unreasonable use.
3. The appliance is designed for cooking rice and heating water only. DO NOT cook any food other than rice. DO NOT put other liquids into it. Different liquids have different boiling points, with volatile liquids having boiling points lower than 100C, the boiling point of water.
4. The installation/assembly of the appliance will be made in accordance with the indications of the manufacturer. A wrong procedure may cause damages to persons, animals or objects, for which the manufacturer cannot be considered responsible.
5. Before use, check the integrity of the appliance and power cable. DO NOT operate the appliance when the Heating Plate or housing is damaged. In case you are not sure, contact a qualified person. If the power cable is damaged, it must be replaced by the manufacturer / service agent or a qualified technician in order to avoid a shock hazard.
6. Before powering the appliance make sure the rating (voltage and frequency) corresponding to the grid and the socket is suitable for the plug of the appliance, and that the wall socket is properly grounded. This appliance is fitted with an earth wire for extra safety.
7. Avoid the use of adapters and/or extension cables; if their use is absolutely necessary, use only materials in compliance with the current safety regulations and whose marked electrical rating should be at least as high as the electrical rating of the appliance. To prevent overloading and blown fuses, ensure that no other high powered appliance is plugged into the same socket.
8. The appliance must NOT be switched on using external timers and/or other remote control appliances which are not specified in this manual.
9. Only use original components & accessories provided by the manufacturer. Any non-original component or accessory NOT recommended by the manufacturer (including, but not limited to, Inner Pots or Lids made by other manufacturers or by the same manufacturer but for other models of the same capacity or otherwise) may cause injuries to persons or damage to the appliance. Doing so will void the warranty and may cause serious injury.
10. The packing materials (plastic bags, expanded polystyrene, etc.) must be kept out of the reach of children or disabled persons since they represent potential sources of danger.

### Location

11. This appliance is NOT suitable to be used or stored near heat sources (open flame, ovens, heaters, stoves, etc.) and/or in an explosive environment (in the presence of flammable substances such as gas, vapour, mist or dust, in atmospheric conditions when, after ignition, the combustion is spread in the air). Items containing these substances should never be placed in the appliance, and never be used to clean the appliance to avert the risk of fire or explosion.
12. The appliance should NOT be placed on a surface, or in the vicinity of objects, which can be damaged by heat, such as carpets, curtains, textiles or plastics. DO NOT use the appliance when placed in a closed cabinet. During operation, as heat is transferred away from the appliance, the surface that the appliance is placed upon as well the surface immediately above or adjacent to it may become very hot. There should be at least 10 cm of free space from the back, left & right sides and at least 20 cm from the top of the appliance to allow adequate air circulation. Never put things on top of the Lid. DO NOT locate multiple portable socket outlets or power supplies at the bottom or rear of the appliance. If the appliance is operated on wooden furniture, use a protective pad to prevent damage to delicate finishes.

13. Avoid placing the power cable (and extension cable, if used) on abrasive or sharp surfaces or in positions where it can be damaged easily. Avoid placing heavy objects on the cable. The cable must NOT be placed under carpets, or covered with throw rugs, runners or similar. Arrange the cable away from the high traffic area, and where it will NOT be tripped over. DO NOT pull or carry the appliance by the cable.
14. DO NOT use or store the appliance outdoors. Store and use the appliance only indoors, or in any case, protected from weathering such as rain, direct radiation of the sun and dust.

### **Operation**

15. If you are using the appliance for the first time, you should:
  - a. Clean the exterior of the appliance with water & detergent with a non-abrasive sponge. DO NOT use metal scouring pads.
  - b. Place and use the appliance upright on a horizontal, stable, dry and heat-resistant surface. Damage to the appliance may occur if it is placed on an incline or decline.
  - c. (First use)
    - Press the Lid Button to release the catch, lift the Lid Handle so that it comes to rest vertically above the Inner Pot.
    - Add water to reach about 80% the height of the pot.
    - Again holding the Lid Handle, lower the Lid back into position with a “click”.
    - Attach the power cable to the appliance and then plug the power cable into the wall socket and switch the wall switch ON.
    - Press the Selector Button downwards. The ‘COOK’ Indicator Light will illuminate and heating commences.
    - Once the water begins to boil, switch off the appliance by pressing the Selector button upwards, switch the wall switch OFF, and unplug the power cable from the wall socket and the appliance. Wait for the water to cool after boiling. Discard the water. Then the appliance is safe to use.
    - Always wear protective, insulated oven gloves when inserting or removing items from the hot appliance.
    - Make sure to remove any label or protective sheet which may prevent its proper functioning.
  - DO NOT:**
    - press the Selector Button or Lid Button too forcefully to avoid any damage;
    - maintain the rice for more than 12 hours in the appliance, even in the ‘WARM’ mode as bacteria may start to multiply and the rice will also lose its flavor;
    - leave the appliance unsupervised during operation.
  - d. (Subsequent uses)
    - Measure the desired amount of rice with the measuring cup supplied and place the rice in a clean container (NOT the Inner Pot!) and rinse the rice with water. Then place the rinsed rice into the Inner Pot and add water. Level the rice inside the Inner Pot, wipe the exterior of the pot dry and place the Inner Pot onto the Outer Pot.
    - Holding the Lid Handle, lower the Lid back into position with a “click”.
    - Attach the power cable to the appliance and then plug the power cable into the wall socket and switch the wall switch ON.
    - Press the Selector Button downwards. The ‘COOK’ Indicator Light will illuminate and heating commences.
    - When the rice is cooked, the Selector will “pop” up and a “click” sound will be heard. Simultaneously, the ‘COOK’ Indicator Light will be replaced by the ‘WARM’ Indicator Light. Press the Lid Button to release the catch, lift the Lid Handle so that it comes to rest vertically above the Inner Pot. Scoop the required quantity of rice out after 15 minutes.
16. During the period of operation, high temperature steam may escape from the Lid and Vapour Hole. To avoid scalding:
  - DO NOT**
    - cover the appliance during functioning;
    - obstruct totally nor partially the Lid;
    - insert objects or body parts inside the protection cover of the appliance;
    - fill the pot with hot water;
    - fill water below 50% & beyond 80% of the maximum volume of the Inner Pot;
    - allow all of the water to be boiled away - however, should the Inner Pot be found empty during operation, immediately switch the wall switch OFF, unplug the power cable and add water to avoid dry-boil;

- lift up the Lid while heating & ensure that the Lid is tightly closed during heating;
  - heat the Stainless Steel Inner Pot by any other means, e.g. heating directly on a gas stove or in a microwave oven as the pot can be deformed as a result;
  - use the Stainless Steel Inner Pot to heat oil or melt butter;
  - add food with its packaging (plastic wrapper, paper, foil, metal can, etc.) still attached without first removing the packaging;
  - place any container inside the appliance;
  - touch any part of the appliance except the Selector Button, Lid Handle or Lid Button during 'COOK' and 'WARM' modes, and just after, the appliance being switched off;
  - move the appliance whilst the appliance is in operation. Wait until cooking has completed, the power turned off, then unplug the socket from the electric mains. Only after making sure that the Lid is securely locked into the appliance, move the appliance by holding the Lid Handle carefully;
  - direct steam at any person or animal & one's hands and face should be angled away from the Lid and Vapour Hole at all times.
17. During operation, DO NOT touch the appliance with wet body parts, and it is recommended to have between you and the standing surface, an isolating element (for example, wearing shoes with rubber soles).
  18. DO NOT soak the Main Body in water or other liquids, wash it under the tap, or let any liquid flow into the internal casing of the appliance to prevent electric shock. In case of accidental fall in water, DO NOT try to take it out. Immediately switch the wall switch OFF and unplug the power cable from the wall socket.
  19. Switch the wall switch OFF before unplugging the appliance. Plug and unplug the power cable firmly holding it with dry hands. Always unplug the power cable to avoid overheating and if it is NOT used for a long period, before storing, assembling & disassembling, cleaning or performing any maintenance operation. Before storing, cleaning or performing any maintenance operation, leave to cool for at least 30 minutes.
  20. In case of malfunction or anomaly during the functioning, such as smoke coming out of the appliance, switch the wall switch OFF and unplug the power cable from the wall socket. Lift the Lid after it has stopped smoking. Check the cause of the anomaly, if possible, with the support of a qualified person.
  21. This appliance is NOT intended for commercial use but to be used in households and similar applications, such as:
    - Staff kitchen areas in shops, offices and other working environments;
    - By clients in dormitories, hotels, motels and other residential environments;
    - Bed and breakfast type environments.
  22. This appliance can be used by children aged from 8 years and above and persons with reduced physical, sensory or mental capabilities or lack of experience and knowledge if they have been given supervision or instruction concerning use of the appliance in a safe way and understand the hazards involved. Children shall NOT play with the appliance. Cleaning and user maintenance shall NOT be made by children unless they are older than 8 and supervised. Keep the appliance and its cable out of reach of children less than 8 years old.
  23. Save these instructions.

## HOW TO USE

1. Measure the desired amount of rice with the measuring cup supplied with this appliance. Add this to a container such a large bowl or pot. One cup contains 180 ml (about 150 g) of rice.

### Important Notice

This is NOT the Inner Pot

It is an ordinary container used to rinse the raw rice



2. Rinse the rice several times until the water in the container becomes relatively clear.
3. DO NOT rinse the rice using the Inner Pot supplied. If the pot is used rinsing rice, the surface of the Stainless Steel may be scratched. The pot may even be dented and the bottom of the pot may become uneven.
4. Place and use the appliance on a horizontal, stable, dry and heat-resistant surface. Damage to the appliance may occur if it is placed on an incline or decline.
5. Put the rinsed rice into the Inner Pot and add water to the corresponding level e.g. if 3 cups of rice was added, then the water level should reach the mark indicating "3". This being only a guide, you can add or reduce the amount of water according to your personal taste. However, DO NOT add water in excess of the "MAX" mark indicated.

Cups of raw rice added	Water added to line on pot
2	3 – 3½
4	5 – 5½
6	7 – 7½
8	9 – 9½
10	11 – 11½
12	12 – 12½
14	14 – 14½
15	15 – 15½

6. Level the rice inside the Inner Pot and wipe the exterior of the pot dry. If the sides or bottom of the Inner Pot is wet, when water comes into contact with the Heating Plate, besides noises emanating from the appliance, it might lead to electrical malfunctions in the appliance. Place the Inner Pot inside the body of the appliance, and ensure that contact between the bottom of the pot and the Heating Plate is evenly distributed. (Rotate the Inner Pot from side to side to achieve this).

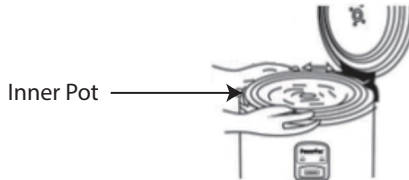

7. Holding the Lid Handle, lower the Lid back into position with a "click". DO NOT open the Lid during the cooking of the rice.
8. Attach the power cable to the appliance and then plug the power cable into the wall socket and switch the wall switch ON. Press the Selector button downwards. The 'COOK' Indicator Light will illuminate and heating will commence. If difficulties are encountered in pressing the Selector button downwards, DO NOT attempt to force it down. This difficulty usually occurs when the Inner Pot is not fully inserted into the appliance, or when cooking has just been completed. If the Selector button is not pressed, the 'WARM' Indicator Light will illuminate and the Inner Pot and contents will be kept warm. However, heat energy provided will NOT be hot enough to cook the rice in the Inner Pot.

9. When the rice is cooked, the Selector will “pop” up and a “click” sound will be heard. Simultaneously, the ‘COOK’ Indicator Light will be replaced by the ‘WARM’ Indicator Light.
10. When cooking congee or soup, the instructions are the same. However, when the cooking is completed, manually PULL UP the Selector button. DO NOT allow the congee or soup to continue being heated in the ‘WARM’ function, or the congee or soup will gradually become a paste.
11. Keep the rice warm after cooking and let it steam for 15 minutes. This will ensure that the rice is “fluffy”. DO NOT keep the rice for more than 12 hours in the appliance in the ‘WARM’ mode as bacteria may start to multiply and the rice will also lose its flavor.
12. Press the Lid Button to release the catch, lift the Lid Handle so that it comes to rest vertically above the Inner Pot. Scoop out the cooked rice from the appliance by using the spoon provided.
13. When all the rice had been removed from the Inner Pot or if the rice has been kept warm for too long and you wish to dispose of it, switch off the appliance by pressing the Selector button upwards, switch the wall switch OFF, and unplug the power cable from the wall socket and the appliance. Wait for the appliance and contents to cool down before removing the Inner Pot from the appliance.

### **To empty the Water Storage Box**

1. Put your hands on the positions as shown in the figure. Use your thumb to press at the location shown. The Water Storage Box opens with a “ka” sound. DO NOT press too hard to prevent water from splashing out or the device cracking.
2. Carefully remove the Water Storage Box as shown in the figure.
3. After emptying and rinsing the Water Storage Box, replace the device as shown in the figure.
4. When the Water Storage Box is correctly aligned in position, use your thumb to carefully push the device inwards until a “ka” sound is heard, signifying that the device is in place.

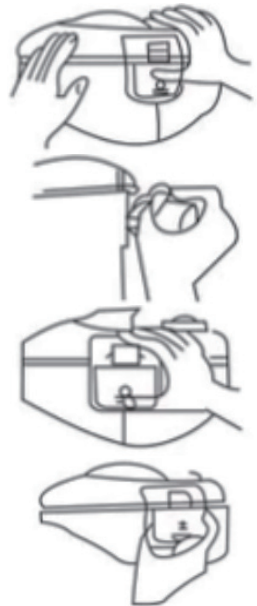

## HOW TO CLEAN

1. Switch the appliance off by pressing the Selector button upwards, switch the wall switch OFF, unplug the power cable from the wall socket and the appliance when not in use and before filling, emptying and cleaning the appliance. Allow sufficient time for the appliance to cool.
2. Remove the Inner Pot and Lid from the body of the appliance. If some rice is still present, adding some warm soapy water to the Inner Pot and leaving it to stand for about 20 minutes might prove helpful in removing the rice later on.
3. Wash the Inner Pot & Lid using water & detergent with a non-abrasive sponge. Dry using a soft cloth and allow to air-dry.  
DO NOT use metal scouring pads as these will scratch the Stainless steel surface of the Inner Pot.
4. Wipe the exterior of the appliance using a soft, damp cloth or sponge. Remove stubborn spots with a cloth moistened with mild liquid detergent. DO NOT use abrasive scouring pads or powders.
5. Never immerse the body of the appliance in water or other liquids. DO NOT immerse the body of the appliance in water or other liquids, wash it under the tap, or let any liquid flow into the internal casing of the appliance to prevent electric shock.
6. The Heating Plate may occasionally have grains of rice or other organic materials stuck to its surface. If left there, contact between the bottom of the pot and the Heating Plate will NOT be evenly distributed. Use fine sandpaper and gently rub down the surface. Use a wet washcloth to remove any remaining food particles.

## PROBLEM SOLVING

PROBLEM	POSSIBLE CAUSES	HOW TO SOLVE
The Heating Plate is NOT hot.  Indicator Light on appliance DOES NOT illuminate.	The appliance is NOT plugged in.	Plug the power cable into the wall socket and switch ON. Press the Selector Button downwards.
	Household power circuit has blown.	Check the household circuit breaker for any tripped wires. Call for a qualified electrician.
	Fuse on appliance has blown.	Send the appliance to the authorised service centre for checks.
The Heating Plate is NOT hot. Indicator Light on appliance illuminates.	Wires connecting the Heating Plate are loosened.	Send the appliance to the authorised service centre for checks.
	Electric Thermal-tube is burnt out.	
The Heating Plate is hot, but either the rice fails to cook properly or the duration to properly cook the rice is too long  Indicator Light on appliance illuminates.	Duration of cooking is insufficient.	Lengthen the duration of cooking in proportion to the amount of food being cooked.
	Grains of rice or other organic materials stuck to the surface of the Heating Plate.	Use fine sandpaper and gently rub down the surface. Use a wet washcloth to remove any remaining food particles
	The Inner Pot or Heating Plate is deformed.	Send the appliance to the authorised service centre for replacement.
	The Inner Pot contains insufficient amount of water.	Refill the Inner Pot with water.



<b>PROBLEM</b>	<b>POSSIBLE CAUSES</b>	<b>HOW TO SOLVE</b>
The Heating Plate is fairly hot, but the rice fails to cook properly. Indicator Light on appliance illuminates intermittently.	Switch on appliance is damaged.	Send the appliance to the authorised service centre for checks.
The Heating Plate is hot, but the rice turns brown on cooling. DOES NOT warm automatically.	Thermostat has malfunctioned.	Send the appliance to the authorised service centre for checks.
The Heating Plate is hot but the Indicator Light on appliance DOES NOT illuminate.	Indicator Light on appliance is damaged.	Send the appliance to the authorised service centre for checks.

## **SPECIFICATION**

**MODEL**

**PPRC612**

**VOLTAGE**

**220-240V~**

**FREQUENCY**

**50/60Hz**

**POWER**

**500W**

**LITRE**

**1.5 L**

## ENVIRONMENTAL TIP

This appliance, along with all other electronic appliances, should, when it is no longer capable of functioning, be disposed with the least possible environmental damage according to the local regulations in your area. In most cases you can discard the appliance at your local recycling centre.

**DISPOSAL:** Do not dispose this appliance as unsorted municipal waste.

Collection of such waste separately for special treatment is necessary.

### Risk of child or animal entrapment

Before you discard this appliance, please remove all doors and leave the shelves inside so that children or animals may not easily get trapped inside.

## WARRANTY

### Warranty Conditions

1. This warranty provides against defective materials and manufacturing faults throughout for two years from the date of purchase of the appliance covering the Motor only, subject to correct usage of the appliance. The warranty on the Compressor is 10 years subject to the same conditions as above.
2. This warranty also does not cover normal wear and tear, replacement of consumable materials and accessories, and the cost of maintenance of the appliance.
3. This warranty does not cover the repair or replacement of part/s damaged by misuse, accidents, negligence, alterations, or modifications in any way, or repairs done by any repair organisation without the prior consent of PowerPac Electrical Pte Ltd.
4. Repair and service are to be performed at: 5 Changi South Lane #03-01 Singapore 486045. A transport fee will be charged for personal doorstep service.
5. The original purchaser of the appliance must furnish proof of purchase to our Service Centre with the email or number as registered during submission of warranty when this appliance is sent for repair/service. Failure to do so may delay the receipt of said repair/service by the customer.
6. Under no circumstances whatsoever shall the serial number be erased, defaced or altered by the customer and/or his representatives, or the dealer and/or his agents. Failure to ensure this shall invalidate the warranty.
7. This warranty is deemed to be void if the defect is caused by the attack of household pests, fire, lightning, natural disasters, pollution, abnormal voltage or the usage of generators.
8. This warranty is valid in Singapore only.
9. This warranty will be honoured subject to the customer's registration of the warranty inclusive of original invoice or valid purchase receipt. Failure to present these documents will result in denial of service. However, if the customer still requests that the defective appliance be repaired, PowerPac Electrical Pte Ltd may, at its discretion, repair the appliance but impose a labour charge, as well as the costs of the replacement parts, to be borne solely by the customer.
10. Please refer to the attached picture for the location of one of our appliance's serial number, as an example.

*Please complete the on-line registration warranty form available on our website. There is no further requirement to send us any hard copy as part of our efforts to save the environment. In accordance with the terms and conditions of this limited warranty as stated above, PowerPac Electrical Pte Ltd, at its expense shall provide free services for the appliance within the warranty period from its date of purchase from our Authorised dealers.*



E-Register scan





*Thank  
you!*  
*for your  
purchase*

CODE  
**THANKYOU15**

WE ARE OFFERING A  
**15% OFF STOREWIDE FOR  
YOUR NEXT PURCHASE AT  
[WWW.POWERPAC.COM.SG](http://WWW.POWERPAC.COM.SG)**



**TERMS AND CONDITIONS**

One time usage with minimum spend of \$30

This promo code is valid within 3 months for purchases made through [powerpac.com.sg](http://powerpac.com.sg)  
This promo code cannot be applied with any promotions, offers and privileges, unless otherwise stated.\*

\*We reserve the right to modify, cancel and limit any promotion or offer.  
In case of any dispute, our company reserves the rights of final and conclusive decision.

THIS IS HOME TRULY

# E Warranty Registration

Please complete the on-line registration warranty form below. There is no further requirement to send us any hard copy as part of our efforts to save the environment.

In accordance with the terms and conditions of this limited warranty as stated below, PowerPac Electrical Pte Ltd, at its expense shall provide free services for the appliance within the warranty period from its date of purchase from our Authorised dealers.

This warranty will be honoured subject to the customer's registration of the warranty inclusive of original invoice or valid purchase receipt. Failure to present these documents will result in denial of service. However, if the customer still requests that the defective appliance be repaired, PowerPac Electrical Pte Ltd may, at its discretion, repair the appliance but impose a labour charge, as well as the costs of the replacement parts, to be borne solely by the customer

E-Register scan



Product Serial No

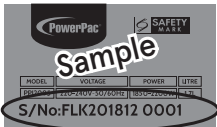

Refer rating label at bottom of product



follow us on  
face book

PowerPacSG 



follow us on  
tiktok

@powerpacsg 



Tanah Merah Stn Exit B »» Bus No. 2/9/48(Stop ID: 85091)  
»» 5 min (4 stops) »» Bef Changi Fire Stn (Stop ID: 85071)  
»» Walk About 6 min, 500m



Simei MRT »» Bus No. 9 (Stop ID: 85079)»» 6 min (3 stops)  
»» Flextronic (Stop ID: 96161) »» Walk About 6 min, 500m

## OFFICE / SERVICE CENTER

PowerPac Electrical Pte Ltd

Tel: 6214 9555

Address: 5 Changi South Lane, #03-01 S(486045)